

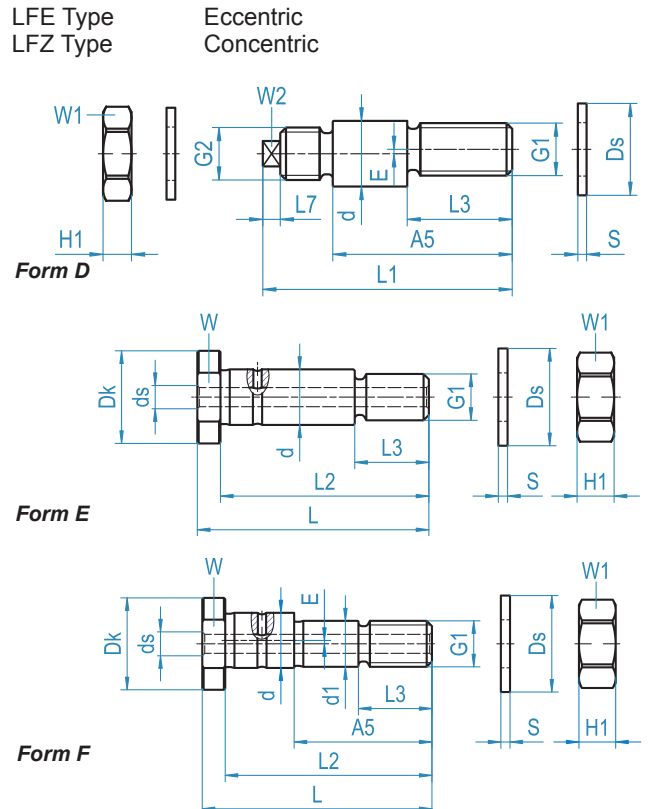

LRG SERIES LFZ/LFE SHAFTS FOR LRG TRACK ROLLERS

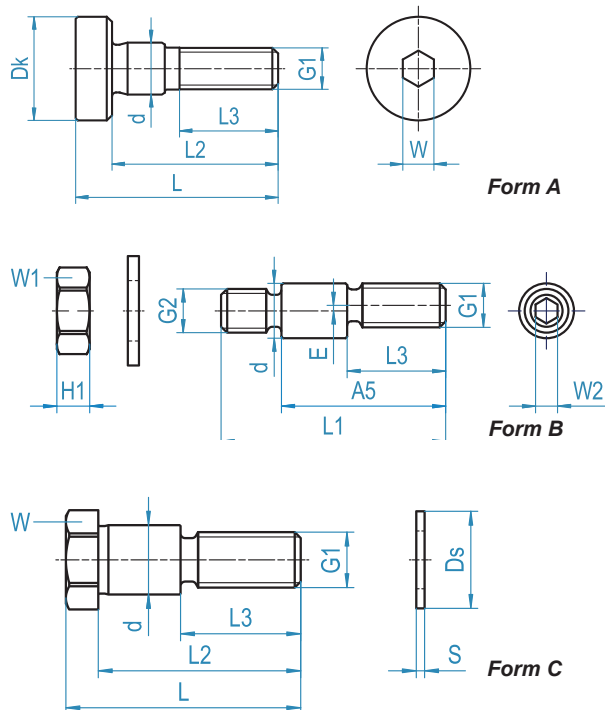

TECHNICAL SPECIFICATIONS



AVAILABLE DIMENSIONS (in mm)

Designation	Form	Dimensions in mm																		
		d	G1	G2	L	L2	L3	L1	A5	L7	Ds	E	H1	S	Dk	ds	d1	W	W1	W2
LFZ 5	A	5	M4	-	19.5	16	9.5	-	-	-	10	-	3	1	10	-	-	3	-	-
LFE 5	B	5	M4	M4	-	-	9	20.5	16	-	-	0.5	3	1	-	-	-	-	7	2
LFZ 8	C	8	M8	-	28.3	24.3	15	-	-	-	14	-	-	1	-	-	-	12	-	-
LFE 8	D	8	M8	M8 x 0.75	-	-	13.7	33.2	22	3.5	14	1	4	1	-	-	-	-	13	5
LFZ 12	C	12	M10	-	43	36	22	-	-	-	20	-	-	1.8	-	-	-	17	-	-
LFE 12	D	12	M10	M10	-	-	19.5	50	33.5	5	21	1	8	1.8	-	-	-	-	17	6
LFZ 12 / M 12	C	12	M12	-	50.8	43.8	24	-	-	-	19	-	-	1.8	-	-	-	17	-	-
LFE 12 / M 12	D	12	M12	M12	-	-	24	57	41	5	19	1	6	1.5	-	-	-	-	17	6
LFZ 15	C	15	M12	-	50.8	43.8	26	-	-	-	21	-	-	2	-	-	-	19	-	-
LFE 15	D	15	M12	M12	-	-	24	57	41	4	21	1	6	2	-	-	-	-	19	6
LFZ12X45-A1	E	12	M10 x 1.5	-	50	45	16	-	-	-	19	-	8	2	20	-	-	17	17	-
LFE12X45-A1	F	12	M10 x 1.5	-	50	45	16	-	30	-	20	0.75	8	2	20	-	10	17	17	-
LFZ20X67-A1	E	20	M16 x 1.5	-	75	67	23	-	-	-	30	-	13	3	30	M8	-	27	24	-
LFE20X67-A1	F	20	M16 x 1.5	-	75	67	23	-	45	-	30	1	13	3	30	M8	17	27	24	-
LFZ25X82-A1	E	25	M20 x 1.5	-	92	82	30	-	-	-	37	-	15	3	40	M8	-	36	30	-
LFE25X82-A1	F	25	M20 x 1.5	-	92	82	30	-	57	-	37	1	16	2.8	40	M8	22	36	30	-